

PLATFORM NORTH

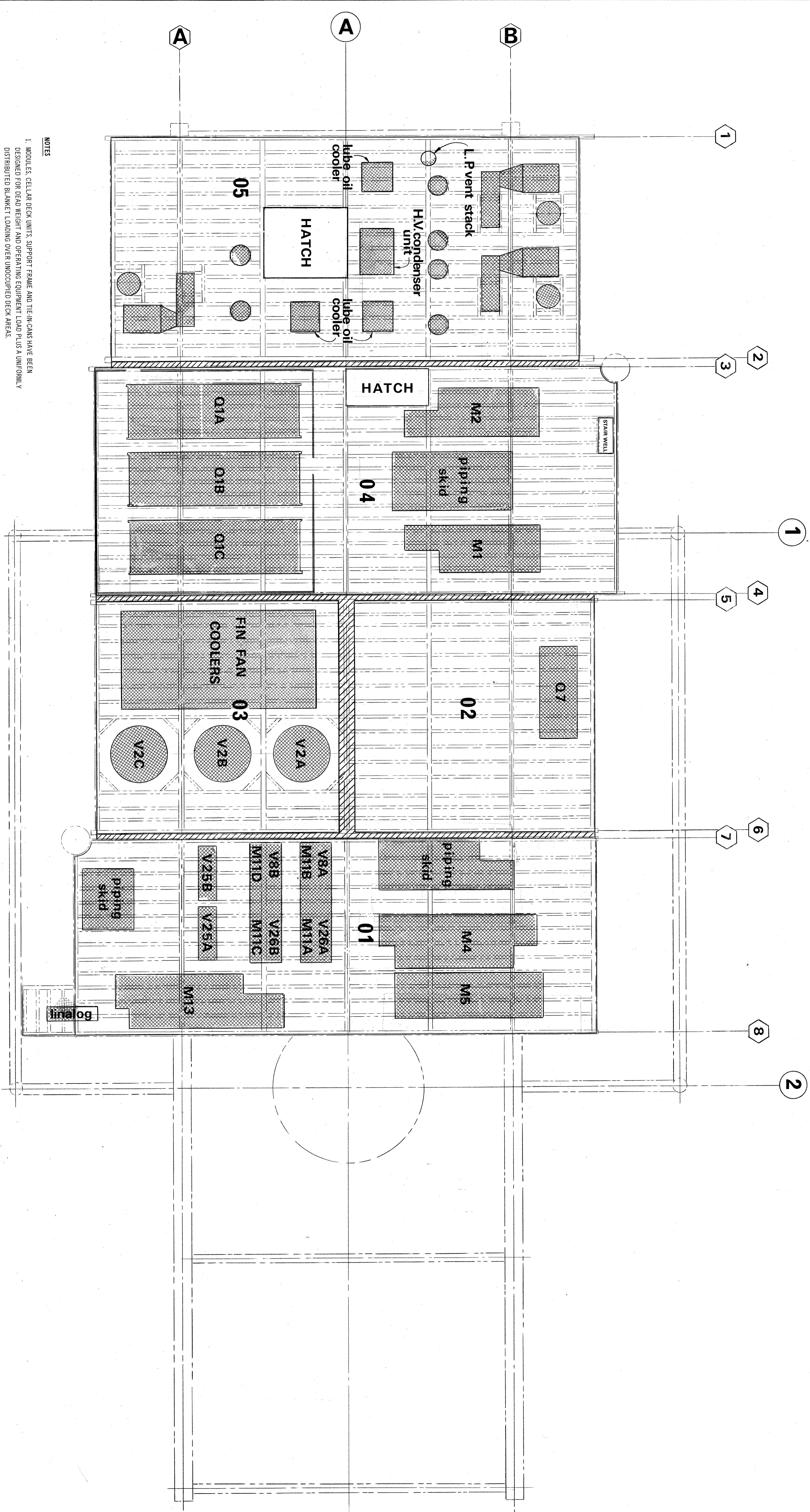

PLAN - MODULE UPPER DECK.

NOTES

1. MODULES, CELLAR DECK UNITS, SUPPORT FRAME AND TIE-IN CANS HAVE BEEN DESIGNED FOR DEAD WEIGHT AND OPERATING EQUIPMENT LOAD PLUS A UNIFORMLY DISTRIBUTED BLANKET LOADING OVER UNOCCUPIED DECK AREAS.
2. FOR MAXIMUM TOTAL ACCUMULATED LOADS PER MODULE SEE NOTE 2 ON DWG. NO. ELN 2099 SH. 2456.
3. - INDICATES RECTOR INSTALLED PLATE.
4. - INDICATES AREA OCCUPIED BY MAJOR ITEM OF EQUIPMENT OR VESSEL. PIPING EXCLUDED FOR CLARITY.
5. FOR MAINTENANCE OPERATIONS, EQUIPMENT, PIPING, VALVES, ETC. MAY BE TRANSPORTED OVER UNOCCUPIED DECK AREAS OF MODULES AND CELLAR DECKS USING RUBBER TYRED VEHICLES OR PALLETIS WHICH DO NOT EXERT MORE THAN 125 PSF (610 KG/M²) UNIFORMLY DISTRIBUTED LOAD WHICH IS NOT TO EXCEED MORE THAN A TOTAL ACCUMULATED LOAD OF 2,250 POUNDS (1,000 KGS) PER VEHICLE OR PALLET. NO MORE THAN ONE (1) PALLET OR VEHICLE MAY OPERATE AT ANY GIVEN TIME OVER ANY GIVEN DECK AREA.
6. ANY ITEM OF EQUIPMENT, PIPING, VALVES, ETC. WHICH WILL EXERT A UNIFORMLY DISTRIBUTED LOAD OF MORE THAN 50 PSF (244 KG/M²) OR MORE THAN THE LOAD APPLICATION DESCRIBED IN NOTE 5, SHALL NOT BE PLACED UPON THE UNOCCUPIED DECK AREAS OF MODULES AND CELLAR DECK UNITS. SUCH ITEMS SHOULD ONLY BE PLACED UPON THE SPECIALLY DESIGNATED LAYDOWN AREA IN CELLAR DECK UNIT 08, UNLESS SUCH ITEM CAN BE IMMEDIATELY PLACED IN ITS PERMANENT POSITION USING PLATFORM CRANES. THE LAYDOWN AREA CAN ACCOMMODATE A TOTAL LOAD OF 70 KIPS (32 TONNES) IMPOSED UPON THAT AREA BY A UNIFORMLY DISTRIBUTED LOAD OF NOT MORE THAN 300 PSF (1465 KG/M²). THE TOTAL LOAD IMPOSED UPON THAT AREA IS TO BE INCLUDED IN THE MAXIMUM TOTAL ACCUMULATED LOAD DESIGNATED FOR CELLAR DECK UNIT 08.

7. THE AREA IN CELLAR DECK UNIT 08 WORKSHOP DESIGNATED FOR HEAVY EQUIPMENT STORAGE CAN ACCOMMODATE A TOTAL LOAD OF 30 KIPS (14 TONNES) IMPOSED UPON THAT AREA BY A UNIFORMLY DISTRIBUTED LOAD OF NOT MORE THAN 300 PSF (244 KG/M²). THE TOTAL LOAD IMPOSED UPON THAT AREA IS TO BE INCLUDED IN THE MAXIMUM TOTAL ACCUMULATED LOAD DESIGNATED FOR CELLAR DECK UNIT 08.

UNIT	OPERATING LOAD
01	3574 KIPS (1667 TONNES)
02	1798 KIPS (818 TONNES)
03	2844 KIPS (1291 TONNES)
04	2403 KIPS (1099 TONNES)
05	1559 KIPS (723 TONNES)

1. OPERATING LOADS PER MTD WEIGHT SCHEDULE, DATED 1 DEC 1976.

2. OPERATING LOADS DO NOT INCLUDE ANY UNIFORMLY DISTRIBUTED BLANKET LOAD OVER UNOCCUPIED DECK AREAS.

REVISIONS			
NO.	DATE	BY	DESCRIPTION
1	24/11/97	AS BUILT	ISSUE

ELF-NORGE A/S
NORWAY

TREATMENT PLATFORM No1
FRING FIELD

MCDERMOTT-HUDSON
LONDON - ENGLAND

Scale: 1:100
Date: 27 JANUARY 1997

Project No: 95.212320331
Rings Field